

FOR ROCKY STURM

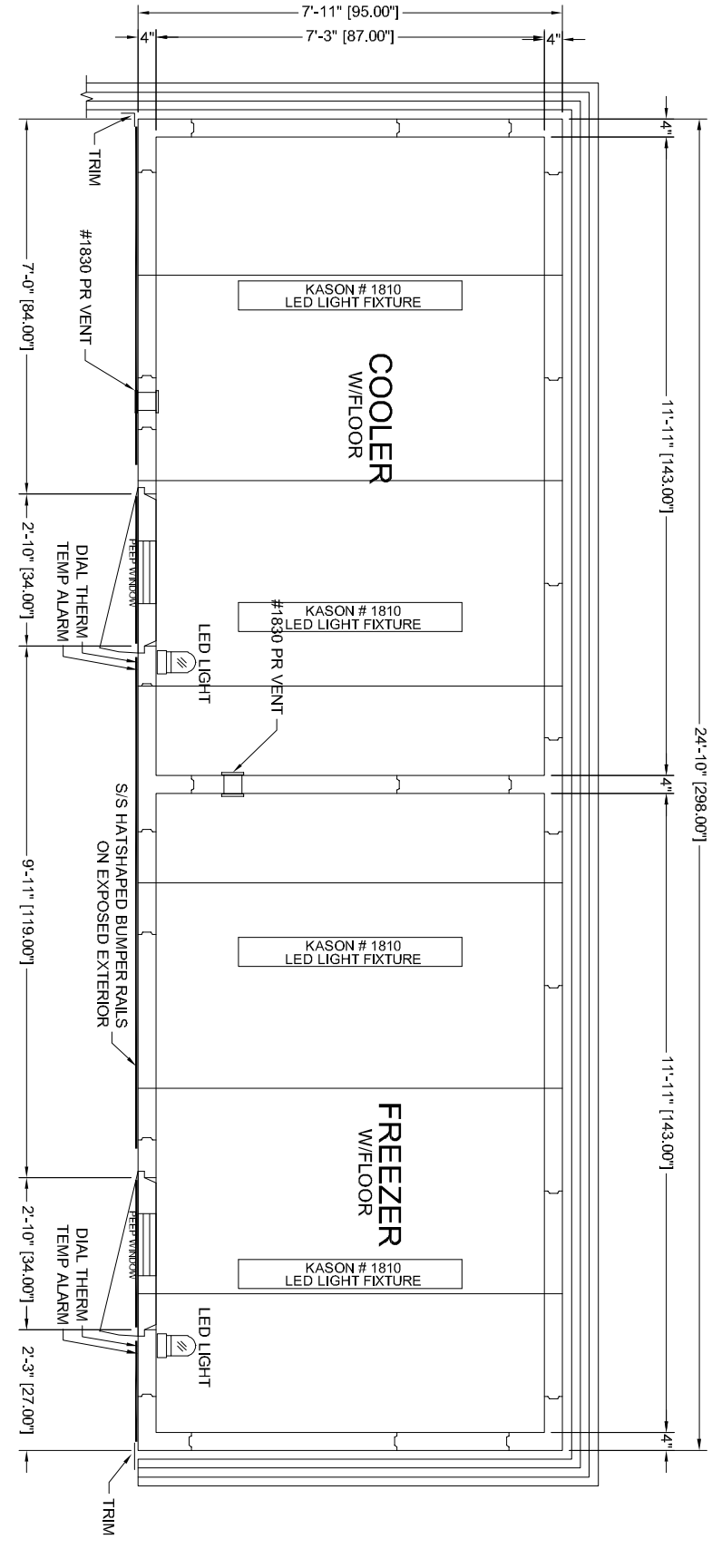

(CONSULTANT: STURM CONSULTING INC.)

TITAN STAIN STEEL BUMPER RAIL DETAIL

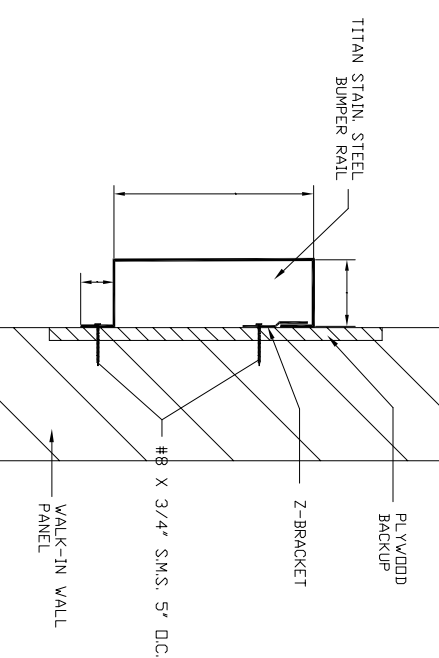

- NOTES:
1. DETAILS FOR SCOUR TO BE 90% SHELLED
2. EDDY EFFECT TO BE CONSIDERED
3. SCOURS INDICATED BY TITAN
5. DISTRIBUTION 1/4\"/>

BUMPER RAIL SCHEDULE

LENGTH	QUANTITY	PIECES
		BP1
		BP2
		BP3
		BP4
		BP5

(SIZES TO BE DETERMINED ONCE JOB IS APPROVED)

Thermo-Kool
WALK-IN PANEL

USA
BIRMINGHAM, AL 35202

INTERNATIONAL: 1-800-453-7223
IN ALABAMA: 205-988-4111

Surface Burning Characteristics

TEST METHOD	CLASSIFICATION
ASTM E136 (UL 94)	CLASS 1
ASTM E1631 (UL 181)	CLASS 1
ASTM E1363 (UL 263)	CLASS 1
ASTM E1630 (UL 104)	CLASS 1

IMPORTANT!
INSTALLATION WALK-IN PANELS MUST BE COMPLETED TO THE PROPER DIMENSIONS TO AVOID VOIDING THE WARRANTY. THE WALK-IN COOLERS AND FREEZERS SHOULD BE INSTALLED TO THE PROPER DIMENSIONS TO AVOID VOIDING THE WARRANTY. THE WALK-IN COOLERS SHOULD BE INSTALLED TO THE PROPER DIMENSIONS TO AVOID VOIDING THE WARRANTY.

WARNING
DO NOT EXPOSE CARTONED OR STACKED PANELS TO MOISTURE OR OTHER LIQUID. MOISTURE OR LIQUID ON THE SURFACE OF THE PANELS MAY CAUSE CORROSION OR DISCOLORATION OF METAL SURFACES. OXIDIZING OF METAL SURFACES MAY OCCUR.

NOTICE
THESE WALK-IN PANELS ARE DESIGNED TO WITHSTAND UP TO 200 LBS OF PRESSURE. THE WALK-IN COOLERS AND FREEZERS MUST BE INSTALLED TO THE PROPER DIMENSIONS TO AVOID VOIDING THE WARRANTY. THE WALK-IN COOLERS SHOULD BE INSTALLED TO THE PROPER DIMENSIONS TO AVOID VOIDING THE WARRANTY.

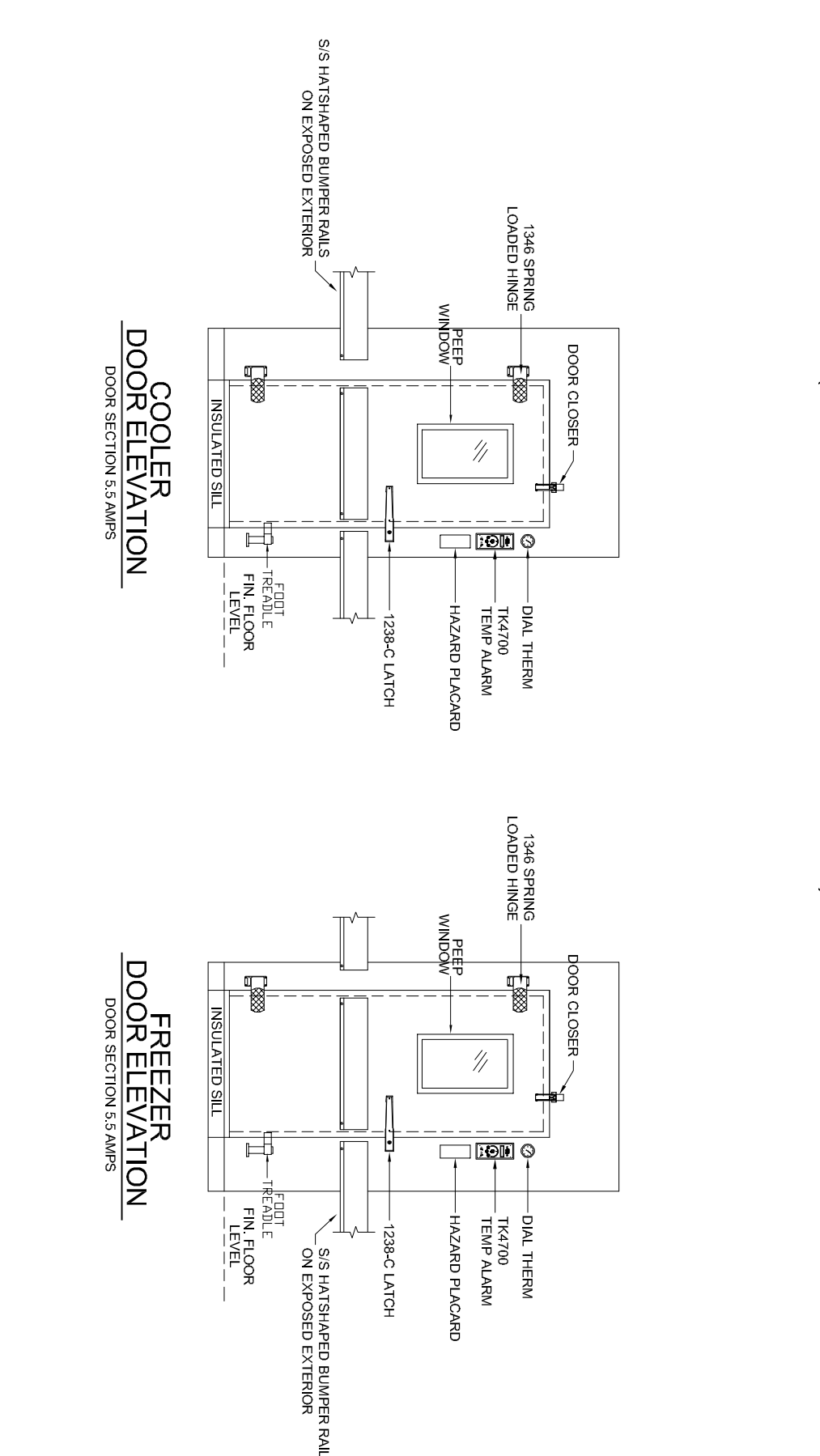

VERIFY HEIGHT OF HEAD & ENCLOSURE PANELS.

NOT APPROVED QUOTATION SUBMITTAL

THESE THERMO-KOOL WALK-IN COOLERS AND FREEZERS CONFORM TO THE NATIONAL FIRE PROTECTION ASSOCIATION (NFPA) 90B SAFETY CODE SECTION 7.10.1, SECTION 7.10.2, AND SECTION 7.10.3. THE WALK-IN COOLERS AND FREEZERS MUST BE INSTALLED TO THE PROPER DIMENSIONS TO AVOID VOIDING THE WARRANTY. THE WALK-IN COOLERS SHOULD BE INSTALLED TO THE PROPER DIMENSIONS TO AVOID VOIDING THE WARRANTY.

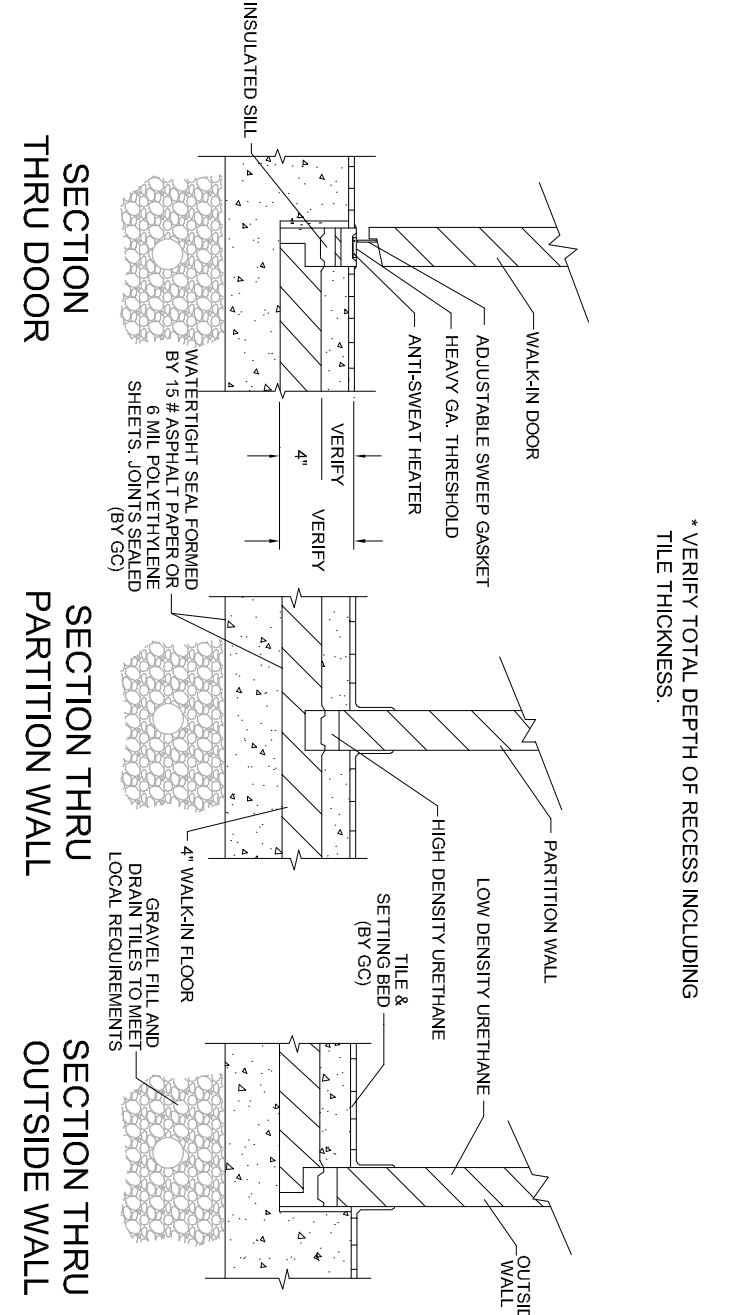

VERIFY TOTAL DEPTH OF RECES INCLUDING TILE THICKNESS

THERMO-KOOL WALK-IN PANELS ARE DESIGNED TO WITHSTAND UP TO 200 LBS OF PRESSURE. THE WALK-IN COOLERS AND FREEZERS MUST BE INSTALLED TO THE PROPER DIMENSIONS TO AVOID VOIDING THE WARRANTY. THE WALK-IN COOLERS SHOULD BE INSTALLED TO THE PROPER DIMENSIONS TO AVOID VOIDING THE WARRANTY.

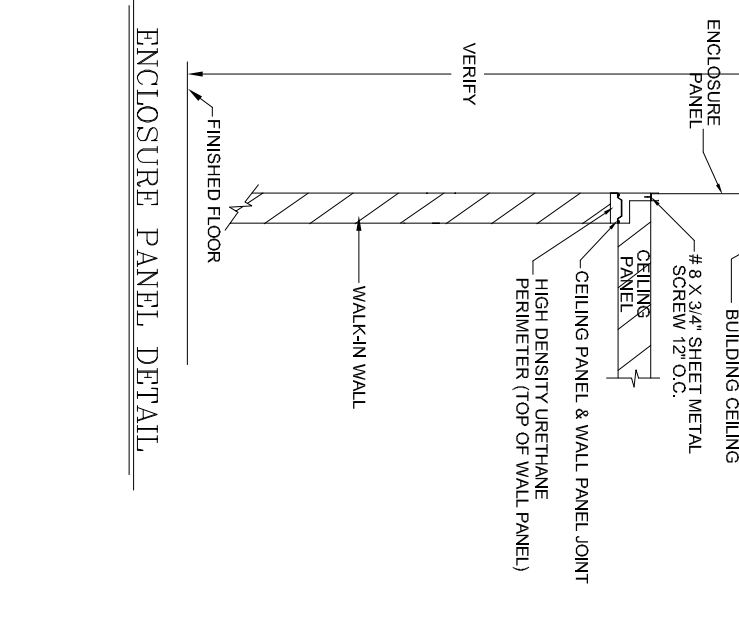

ITEM # 21

DATE: REF: BY:

NSF

NOTES: Approved condensing units should be placed in a well ventilated area with an airflow of 200 CFM per ton of cooling capacity. The condensing unit should be installed in a well ventilated area with an airflow of 200 CFM per ton of cooling capacity. The condensing unit should be installed in a well ventilated area with an airflow of 200 CFM per ton of cooling capacity.

CONDENSING UNIT OPTIONS:
 Condensing Unit Outdoor
 500 BTU/hr Condensate
 Top Mounted Self Condensate
 Top Mounted Condensate with Fan
 400 BTU/hr Condensate with Fan
 600 BTU/hr Condensate with Fan
 800 BTU/hr Condensate with Fan
 1000 BTU/hr Condensate with Fan
 1200 BTU/hr Condensate with Fan
 1400 BTU/hr Condensate with Fan
 1600 BTU/hr Condensate with Fan
 1800 BTU/hr Condensate with Fan
 2000 BTU/hr Condensate with Fan
 2200 BTU/hr Condensate with Fan
 2400 BTU/hr Condensate with Fan
 2600 BTU/hr Condensate with Fan
 2800 BTU/hr Condensate with Fan
 3000 BTU/hr Condensate with Fan

COOLING UNIT OPTIONS:
 Expansion Valve
 Dryer
 Temperature Control
 Programmable Temperature Control
 Pressure Control
 Moisture Sensor
 Gas Inlet Valve
 Gas Outlet Valve
 Oil Monitoring Kit

MOORE PUBLIC SCHOOLS - CHILD CARE
 PROJECT NO. MOORE-OK
 OR BY: KOO
 DATE: 07/20/24
 DWG NO: Q44596-55
 SHEET NO: 17

